

SHAW HARDWOODS™ FLOORING

VENETIAN 7/16" X 3" ENGINEERED PLANK

AVALON 3/8" X 3" ENGINEERED PLANK

VENETIAN 7/16" X 3" ENGINEERED PLANK

AVALON 3/8" X 3" ENGINEERED PLANK

PLEASE READ AND REVIEW THE ENTIRE INSTALLATION INSTRUCTIONS BEFORE PROCEEDING WITH THE ACTUAL INSTALLATION

GLUE DOWN INSTALLATION INSTRUCTIONS

REQUIRED TOOLS AND ACCESSORIES

- * ShawBond 200™ Hardwood Flooring Adhesive
- * 1/4" x 1/4" Notch Trowel
- * Shaw Adhesive Remover
- * Damp and Dry Towels
- * Hand Saw or Electric Saw (Recommend Carbide Tip Blade)
- * 6' Straight Edge
- * Carpenter's Square
- * Soft Rubber Mallet
- * Tape Measure
- * Utility Knife
- * Broom
- * Spacers (1/2")
- * Pull Bar
- * Safety Equipment (Goggles & Mask)
- * 100 or 150 lb. roller

SUBFLOOR PREPARATION

Approved Subfloor Types:

1. APA approved 5/8" minimum thickness, preferred 3/4" or thicker exterior plywood. Note: When installing approved plywood, refer to specific structural panel manufacturer's instructions or contact the APA.
2. 3/4" (23/32") OSB on 16" center floor joists properly nailed
3. Concrete slab.
4. Existing wood floors (installed at right angle only)

Subfloors must be:

- CLEAN - Scraped or sanded, swept, free of wax, grease, paint, oil and other debris

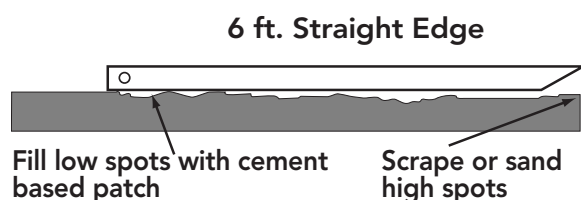

- LEVEL/FLAT - Within 3/16" in 10' and/or 1/8" on 6'. Sand high areas or joints, fill low areas (no more than 1/8") with a cement based patch.
- STRUCTURALLY SOUND - Nail or screw any loose areas that squeak. Replace any aged sub-flooring or underlayments.
- DRY - Moisture content of the subfloor must not exceed 14% on a wood moisture meter, or read more than a 5% difference than moisture content of product being installed.

Concrete Slabs: It is acceptable to adhere approved Shaw Engineered Hardwood Flooring™ Products directly to a concrete slab subfloor. However, all concrete subfloors should be tested for moisture content. Below are methods to test for moisture:

- Tape down 2' x 2' polyfilm squares (a garbage bag or plastic drop cloth will do) in several places on the floor. Wait 24 -48 hours, then check for the appearance of condensation on the inside of the bag or plastic or for a darkening of the concrete subfloor. Either occurrence signals the likely presence of excess moisture, requiring a Calcium Chloride Test. Do not proceed with the installation without performing one of the following tests.
- Perform a Calcium Chloride test. The maximum acceptable reading is 3 lbs./24 hours/1000 sq. ft. for moisture emissions and a pH reading of 6-9 on a number scale of 1-14.
- Use a Delmhorst moisture meter, Model G-40 or Tramex Concrete Encounter. Check the subfloor in several locations.

Remember: The moisture content of the subfloor must not exceed 14% on the moisture meter or read more than a 5% difference than the moisture content of the product being installed.

If too much moisture exists, do not install the floor. Contact your Shaw Hardwood Dealer for options.

Wood Type Floors: Make sure wood type subfloor is dry and well nailed or screwed down every 6" along each joist to avoid squeaking or popping before the flooring is installed. Level any raised edges by rough-sanding. When installing over old wood floors, install new flooring at right angles to the subfloor.

Important: Do not install any Shaw Hardwood Flooring™ Product using the glue down installation method over any vinyl asbestos flooring, vinyl composition tile, linoleum, asphalt tile, ceramic or stone tile, carpet or vinyl sheet products. Use the Floating Floor Installation Method.

Installations Below the Soil Line: All Engineered Shaw Hardwood Flooring™ products can be installed on, above, or below the outside soil line. Below grade installations require that not only the floor, but all surfaces exposed to the ground are to be effectively water/moisture proofed prior to installation.

Important: If a room or subfloor on, above or below the soil line has too much moisture, correct the problem before installing any Shaw Hardwood Flooring™ product.

Important: Do Not use Venetian and Avalon on Radiant Heat Flooring.

JOB SITE PREPARATION

- Undercut door casings.
- Remove any existing wall base, shoe molding, quarter round or doorway threshold.

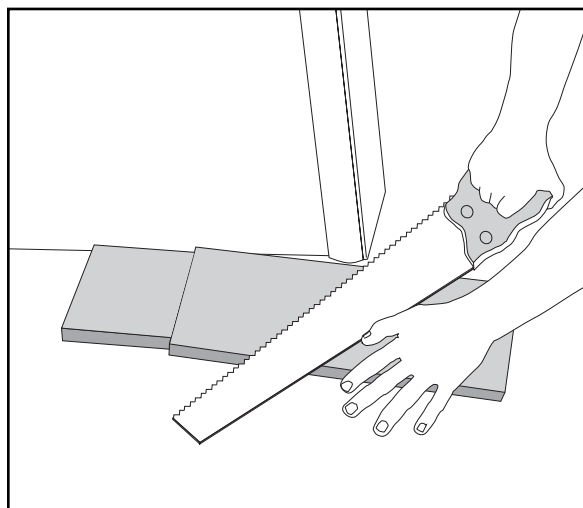

Step 1: GETTING STARTED

Install the flooring parallel to the longest outside (exterior) wall in the room. Measure out from the wall on the door side of the room in two places; 30 3/4" for 3" wide products. Mark and snap a chalk line across the two marks. The area between the chalk line and the wall is the working area and will be the last to be installed.

Note: The use of installation straps may prove helpful for securing boards together. Installation Straps are a handy tool that will insure a tight fit when used to strap each continuous row of installation.

Note: To cut the boards, always saw with the teeth cutting down into the face or top of the board. Cutting from the top down helps protect the surface.

Note: Larger rooms require additional expansion space. Add 1/16" to the width of the spacers for every 3' the room extends beyond 25'.

Step 2: SPREADING THE ADHESIVE

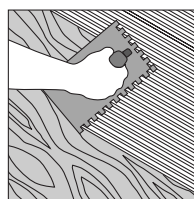

3/16" x 3/16" x 3/16" Square Notch Trowel

Hold the 3/16" x 3/16" x 3/16" trowel at a 45° - 60° angle and spread adhesive onto an area no larger than 30 - 40 square feet at one time. Wood must be set into the glue within 30-45 minutes. Maximum available working time is 45 - 50 minutes. (Colder temperatures or high humidity will extend times and warmer temperatures or low humidity will shorten times.) Do not install wood flooring material after adhesive dries. Test by touching adhesive. If not readily transferred to finger, adhesive is already dried. If adhesive has dried, remove adhesive and apply new material. Periodically check wood to confirm 100% adhesive transfer. Within one hour of setting wood, roll the installation with a 100 - 150 lb. Roller to promote good contact with the adhesive.

Important: Always refer to the specific instructions on the ShawBond 200™ Hardwood Flooring Adhesive label.

Step 3: INSTALLING THE FLOOR

Important: The flooring should be installed from several cartons at the same time to insure proper color, grain and shade mix.

1. After the adhesive has been spread following the above mentioned instructions, start with the first piece of flooring. Install the piece of wood with the groove towards you and the tongue facing the chalk line (starting wall). Line up the tongue of the flooring with the chalk line then press the flooring into the adhesive.

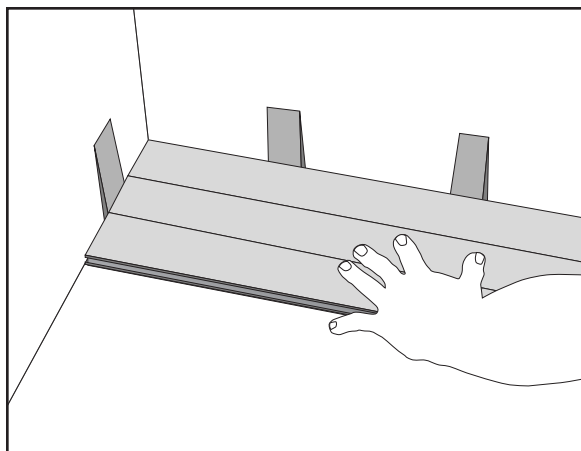

2. Working from left to right, lay the next board and continue working towards the right until you need to cut a piece to complete the first row. Measure the size you need to complete the first row and cut to length. The balance of the piece you cut will start the next row. If the left over piece is less than 6" long, cut another piece at a random spot, and start the second row with it. Be attentive to staggering the ends of the boards at least 18" in adjacent rows to avoid clustering end joints. A soft rubber mallet can be used to tap the boards on the face until they are pulled into proper position.

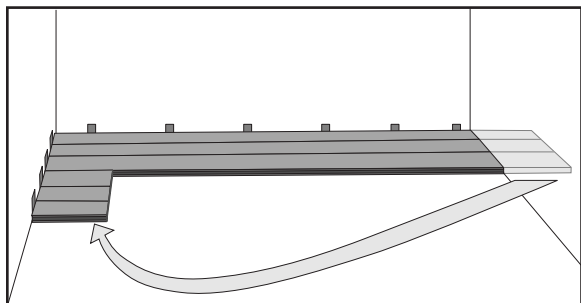

3. **For Wood Subfloors:** If you are working on a wood type subfloor, use small finishing nails to hold the first row in place. Fill nail holes with Shaw Hardwood™ Filler which is manufactured to blend with your flooring.

For Concrete Subfloors: If you are working on a concrete subfloor, take a piece of 1" x 2" x 8' pine board and using 1" concrete nails, nail the board onto the dry side of your chalk line. This will hold your first row of starter boards in place.

Complete the rest of the installation in your working area by following the same installation procedures that are stated in part 2 of this section above.

Important: Make sure that there is 100% contact between the board and the ShawBond 200™ Hardwood Flooring Adhesive.

Note: If any excess adhesive squeezes up to the finished surface, wipe it off immediately using a water dampened cloth or Shaw Adhesive Remover. Then dry the surface and buff with a dry cloth. If the adhesive has dried, use a soft white cloth moistened with Shaw Adhesive Remover. Do not scratch the wood surface.

Step 5: INSTALLING THE LAST ROW

Most often the entire length of the last row will need to be cut so that it is narrow enough to fit the remaining space. When this occurs, follow this simple procedure:

- Lay a row of boards, unglued, with the tongue toward the wall, directly on top of the last row installed.
- Take a full width scrap piece of the Shaw Hardwood™ product that is being installed and lay it on top of the piece to be fit with the tongue side against the wall. Use 1/2" spacers against the wall to ensure the proper expansion space.

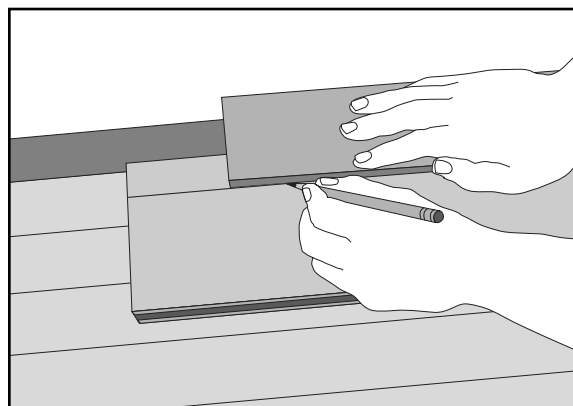

- Draw a line along the row moving down the wall. The resulting line gives the proper width for the last row which, when cut, can then be wedged into place using the pull bar. You will need to use the Pull Bar extensively to make the last row properly flush.