

Installation Instructions

SHAW HARDWOODS™ FLOORING

ENGINEERED LONGSTRIP WITH HDF CORE BRIDGEPORT 5/16" x 7 1/2" LONGSTRIP PLANK WITH HDF CORE

PLEASE READ AND REVIEW THE ENTIRE
INSTALLATION INSTRUCTIONS BEFORE PRO-
CEEDING WITH THE ACTUAL INSTALLATION

FLOATING INSTALLATION INSTRUCTIONS

REQUIRED TOOLS AND ACCESSORIES

- * Tape Measure
- * Pull Bar
- * Hand Saw or Electric Saw (Recommend Carbide Tip Blade)
- * Carpenter's Square
- * Tapping Block
- * Hammer
- * Spacers (1/4")
- * Utility Knife
- * Shaw Hardwoods™ Tongue & Groove Adhesive
- * Foam Underlayment
- * Broom
- * Safety Equipment (Goggles & Mask)
- * Chalk Line and Chalk
- * Shaw Adhesive Remover
- * Damp and Dry towels
- * Shaw Installation Straps
- * 6' Straight Edge

SUBFLOOR PREPARATION

Approved Subfloor Types:

Shaw Hardwoods™ products which have been approved for the floating installation method can be installed over any dry, level, sound subfloor surface except for carpet. All subfloors should be covered with either Silent Step™ "3 in 1" Underlayment or an approved 1/8" thick foam underlayment. When using a 1/8" thick foam underlayment over a concrete subfloor, you must also use a 6 mil. polyethylene film which acts as a vapor barrier.

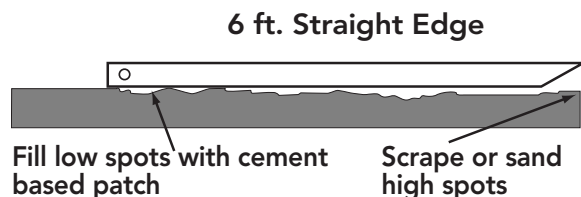

Subfloors must be:

- CLEAN - Scraped or sanded, swept, free of

- wax, grease, paint, oil and other debris
- SMOOTH/FLAT - Within 1/8" on 6'. Sand high areas or joints, fill low areas (no more than 1/8") with a cement-based patch no less than 3000 p.s.i.
- STRUCTURALLY SOUND - Nail or screw any loose areas that squeak. Replace any water damaged sub-flooring or underlayments.
- DRY - Moisture content of the subfloor must not exceed 14% on a wood moisture meter, or read more than a 5% difference than moisture content of product being installed.

Concrete Slabs: Must have a minimum of 6 mil polyfilm vapor barrier secured to the slab. All concrete subfloors should be tested for moisture content. Below are methods to test for moisture:

- Tape down 2' x 2' polyfilm squares (a garbage bag or plastic drop cloth will do) in several places on the floor. Wait 24 - 48 hours, then check for the appearance of condensation on the inside of the bag or plastic or for a darkening of the concrete subfloor. Either occurrence signals the likely presence of excess moisture, requiring a Calcium Chloride Test.
- Perform a Calcium Chloride test, the maximum acceptable reading is 3-lbs. 24hours/1000 sq.ft.
- Use a Delmhorst moisture meter, Model G-40 or Tramex Concrete Encounter. Check the subfloor in several locations

Remember: The moisture content of the subfloor must not exceed 14% on the moisture meter, or read more than a 5% difference than the moisture content of the product being installed.

Important: If a room or subfloor has too much moisture, correct the problem before installing any Shaw Hardwoods™ flooring product.

Below Grade: All Shaw engineered hardwood products, when installed using the floating installation method, can be installed below grade. However, the following instructions must be followed prior to installation:

The concrete slab should be sealed or painted with a good concrete sealer. Then Shaw Silent Step™ "3 in 1" Underlayment or the 6 mil. poly film should be installed with ends butted together and taped with a clear 2" packaging tape to prevent any moisture from coming up through the seams. The Silent Step™ "3 in 1" Underlayment or 6 mil. poly film should be lapped up the wall 4" all the way around the room. This can

be trimmed off after moldings are installed. If you are using the Silent Step™ “3 in 1” Underlayment, you are ready to begin the installation. However, if you have used the 6 mil. poly film, roll out on top of the 6 mil poly film a 1/8” thick foam butting the edges, but not overlapping.

Important: Do not Install Bridgeport over Radiant Heat Subfloors.

JOBSITE PREPARATION

- Acclimate product (in sealed cartons) for 48 hours prior to installation
- Verify floor is SMOOTH/FLAT and structurally sound; repair as needed
- Undercut door casings.
- Remove any existing wall base, shoe molding, quarter round or doorway threshold.

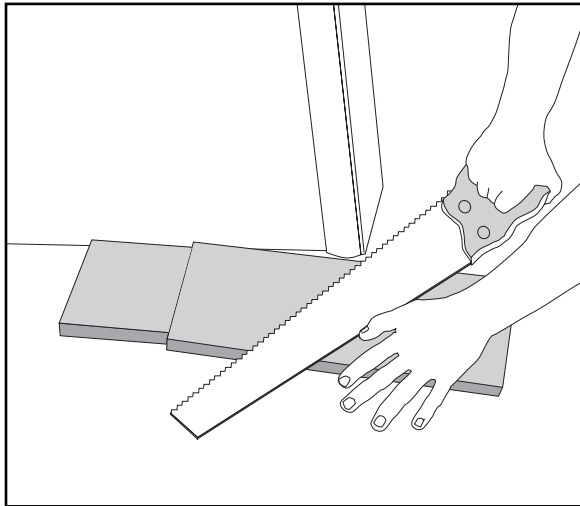

Step 1: POSITION THE FIRST ROW

Important: The flooring should be installed from several cartons at the same time to insure proper color, grain, and shade mix. Open cartons as you use them.

1. Before starting, first measure the width of the room, and then divide the room’s width by the width of the plank. If this means that the last row of planks will be narrower than 2”, then you will need to cut the first row of planks to make it narrower. Cut in such a way that both rows of planks (the first and last to be installed in the room) will have the same approximate width for an overall continuous look. See “Installing the last row.”

Note: To cut the boards, always saw with the teeth cutting down into the face or top of the board. Cutting from the top down helps protect the surface.

2. Begin the installation of the planks in the left hand corner of the room with the long direction parallel to the incoming sunlight source or to the longest wall of the room (if this is possible).

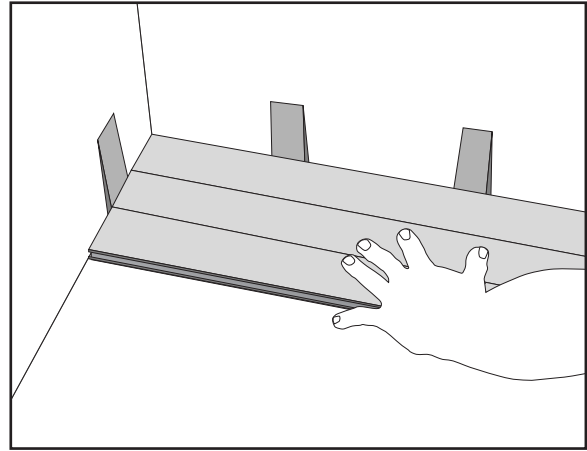

Be sure to install the first row of boards with the groove side facing the wall. Use 1/4” expansion spacers to provide a gap for the seasonal expansion of the flooring along the walls of the entire room. Always place expansion spacers against the wall where the two boards meet. This will make maintaining a good square seem easier.

Note: Larger rooms require additional expansion space. Add 1/16” to the width of the spacers for every 3’ the room extends beyond 25’. Dimensions exceeding 40’ require the use of a T-Molding for expansion.

3. If the starting wall is out of square, it will be necessary to scribe the first row to match the wall, allowing the opposite side of the row to present a true square base for the rest of the floor. When the first row is complete, you must have a straight, even base established.

Step 2: GLUING THE BOARDS TOGETHER

When installing the Shaw Hardwood™ Flooring products which have been approved for the floating installation method, the boards must be side and end glued using Shaw Hardwoods™ Tongue & Groove Adhesive. **Fill grooves only 1/2 full.**

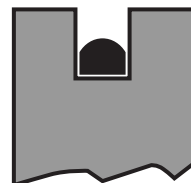

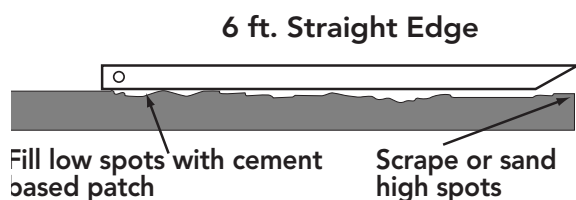

Always apply the adhesive into the bottom of the groove on each board. Apply a continuous bead, filling the groove no more than halfway full. **Do not fill the groove.** Start & stop adhesive 6" from the ends on the long side of the board. Apply 3" of adhesive in the center of the butt end, this will leave about 2" at the ends without glue.

Note: The use of installation straps may prove helpful for securing boards together. Installation straps are a handy tool that will insure a tight fit when used to strap each continuous row of wood.

Note: If any excess adhesive squeezes up to the finished surface, wipe it off immediately using a water dampened cloth or Shaw Adhesive Remover. Then dry the surface and buff with a dry cloth. If the adhesive has dried, use a soft white cloth moistened with Shaw Adhesive Remover. Do not abrade the wood surface.

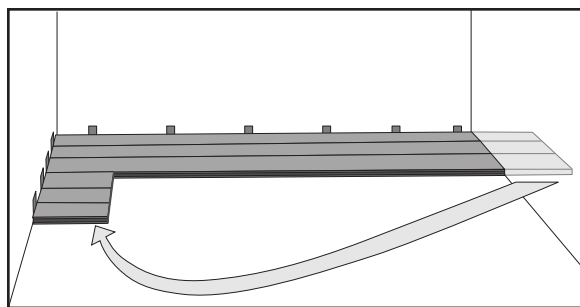

Step 3: INSTALLING THE REST OF THE FLOOR

Note: Always stagger 18" between end joints of adjacent board rows. The end joints should not repeat visually across the installed floor.

After installing the first row of boards, apply the adhesive to the first board on the second row using the above gluing instructions. Connect that board to the first row making sure that there is at least an 18" stagger between the end joint of the board on the first row. Tap the boards together with a tapping block. Be sure that the tapping block is against the tongue only and use only a gentle tapping motion to

tap the boards together. Excessive force will damage the board making it difficult to install additional boards. Do not tap on the groove side of the boards as this will cause damage to the boards. Once the board has been tapped into place, check for a tight fit on sides and ends. To install the rest of the flooring, continue placing the boards from left to right, plank by plank, and row by row.

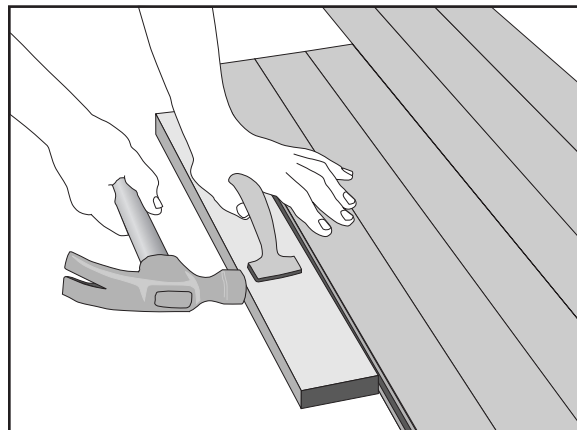

Note: When installing around fixed objects, small areas or even in general installation areas, the use of installation straps may prove helpful for securing boards together. Installation Straps are a handy tool that will insure a tight fit when used to strap each continuous row of installation.

Step 4: INSTALLING THE LAST ROW

Most often the entire length of the last row will need to be cut so that it is narrow enough to fit the remaining space. When this occurs, follow this simple procedure:

- Lay a row of boards, unglued, with the tongue toward the wall, directly on top of the last row installed.
- Take a full width scrap piece of the Shaw Hardwoods™ product that is being installed with the tongue side against the wall. Use 1/4" spacers against the wall to ensure the proper expansion space

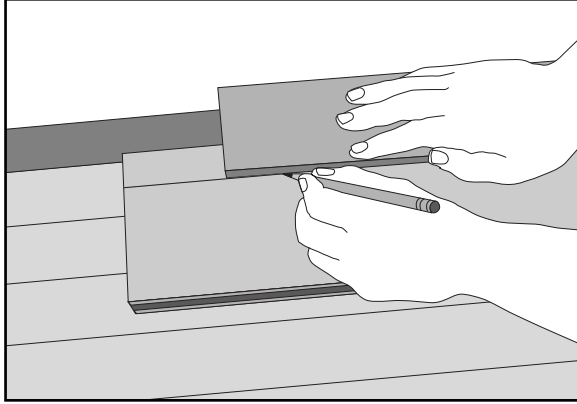

- Draw a line along the row moving down the wall. The resulting line gives the proper width for the last row which, when cut, can then be wedged into place using the pull bar.

Note: A drying time of 24 hours is recommended before any damp mopping, cleaning or heavy objects or furniture can be put back into place.

Make sure when the installation is complete that the spacers are removed and the expansion space is covered with an appropriate molding as described in **MOLDINGS, TRIMS & TRANSITION PIECES**.